

## JACOBS® TAPERS AND MOUNTS

The tables below reproduce and classify the normal dimensions of Jacobs® tapers and mounts. They also observe the generally accepted designation. In effect, the range of increasing values for diameter D contains two No. 2 tapers, the first of which is No. 2 short taper. Between the tapers 2 and 3, there are two interpolated tapers which bear the out-of-series numbers 33 and 6 respectively.

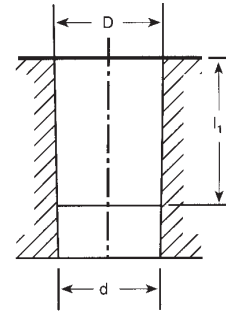

Jacobs Taper No	D		d		l <sub>1</sub>		Taper on Diameter	
	in.	mm	in.	mm	in.	mm	in.	mm
0	0.250 0	6.350	0.228 4	5.802	0.437 50	11.112	0.591 45	15.023
1	0.384 0	9.754	0.333 4	8.469	0.565 25	16.669	0.925 08	23.497
2 short	0.548 8	13.940	0.487 6	12.386	0.750 00	19.050	0.978 61	24.857
2	0.559 0	14.199	0.487 6	12.386	0.875 00	22.225	0.978 61	24.857
33	0.624 0	15.850	0.560 5	14.237	1.000 00	25.400	0.761 94	19.353
6	0.676 0	17.170	0.624 1	15.852	1.000 00	25.400	0.622 92	15.822
3	0.811 0	20.599	0.746 1	18.951	1.218 75	30.956	0.638 98	16.230
4	1.124 0	28.550	1.037 2	26.346	1.656 25	42.069	0.628 86	15.973
5	1.413 0	35.890	1.316 1	33.422	1.875 00	47.625	0.620 10	15.773

## JACOBS® STANDARD THREADED MOUNTS

5/16 - 24

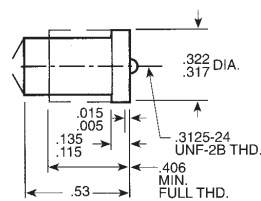

3/8 - 24

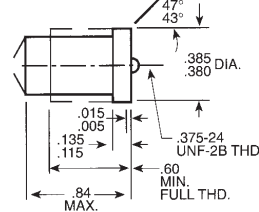

1/2 - 20

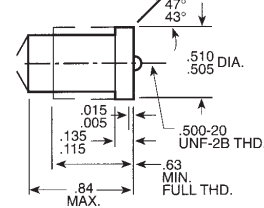

5/8 - 16

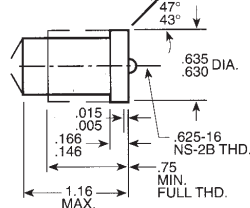

3/4 - 16

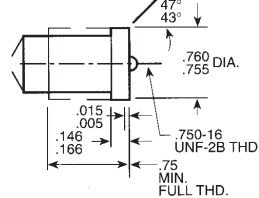

## JACOBS® STANDARD STRAIGHT MOUNT

.625STR

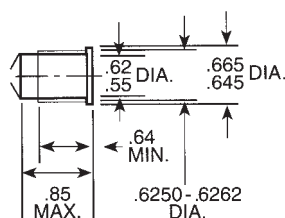

**NOTE:**

All dimensions are in inches unless otherwise specified.

**CAUTION:**

When designing for new applications, contact the Engineering Department, The Jacobs® Chuck Manufacturing Company for current specifications.